

## Installation instructions

Attention : Read carefully from beginning to end before installation!

### Installation Instructions as herringbone

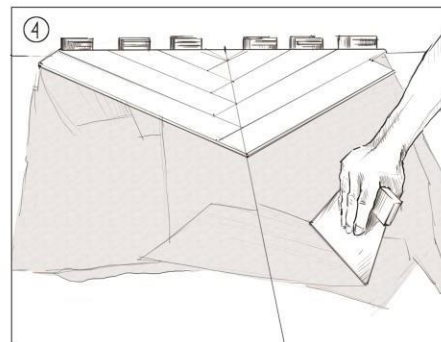
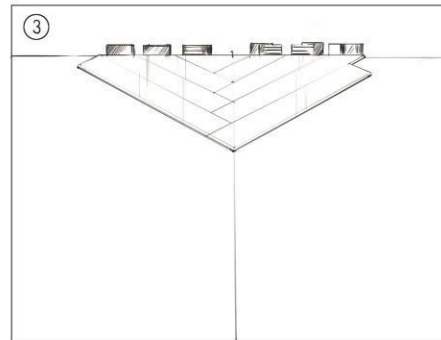
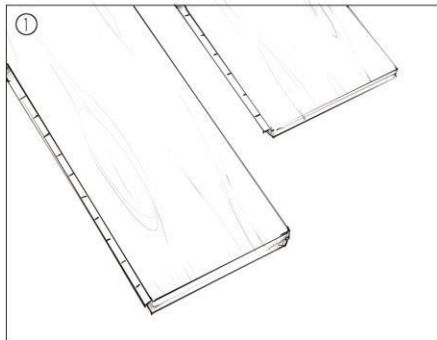

Picture 1:

Left board. Right board. Right and left boards are required for the herringbone installation

Picture 2 :

Left and right stripes are packed together.

Lay out boards, sort and prepare them before installation.

Picture 3:

Lay out and fit together some double rows without adhesive. The chalk line (center of the picture)

runs through the center of the room.

Picture 4 :

Apply adhesive along the chalk line laid out in the center. Install the boards previously laid out and fitted together into the adhesive layer. Only apply enough adhesive to lay stripes in 15 minutes ( coverage : 800-1000 mg / m<sup>2</sup>).

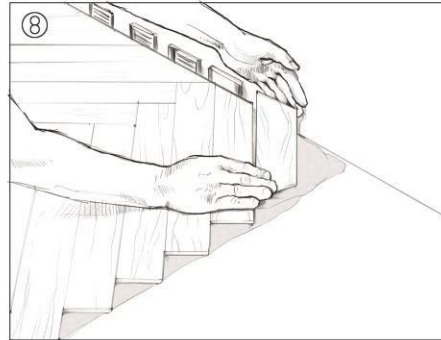
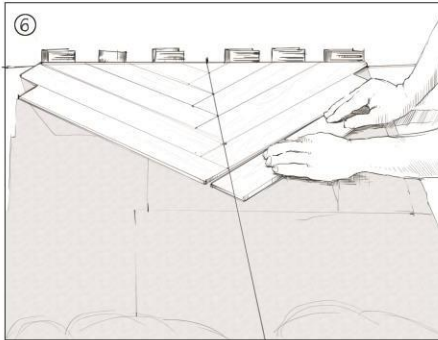
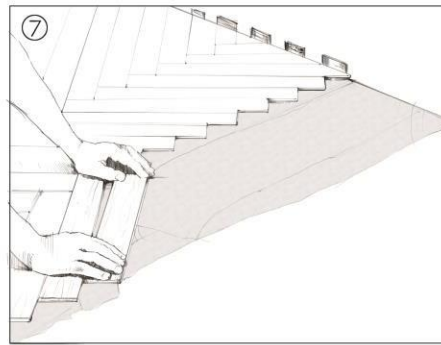
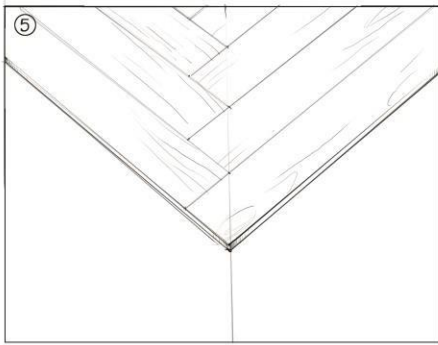

Picture 5:

The herringbone peaks run along the chalk line.

Picture 6:

Glue the first herringbone double row along the chalk line and lay on both sides up to the wall.

Picture 7:

Lay more rows left and right from the center up to the wall.

Picture 8:

In the wall area fit in cut-off boards with 45 saw cut (calculate approx. 10 mm wall spacing all-around). In door thresholds you can lay the boards with no need to calculate the extension space.

## PATTERN INSTALLATION

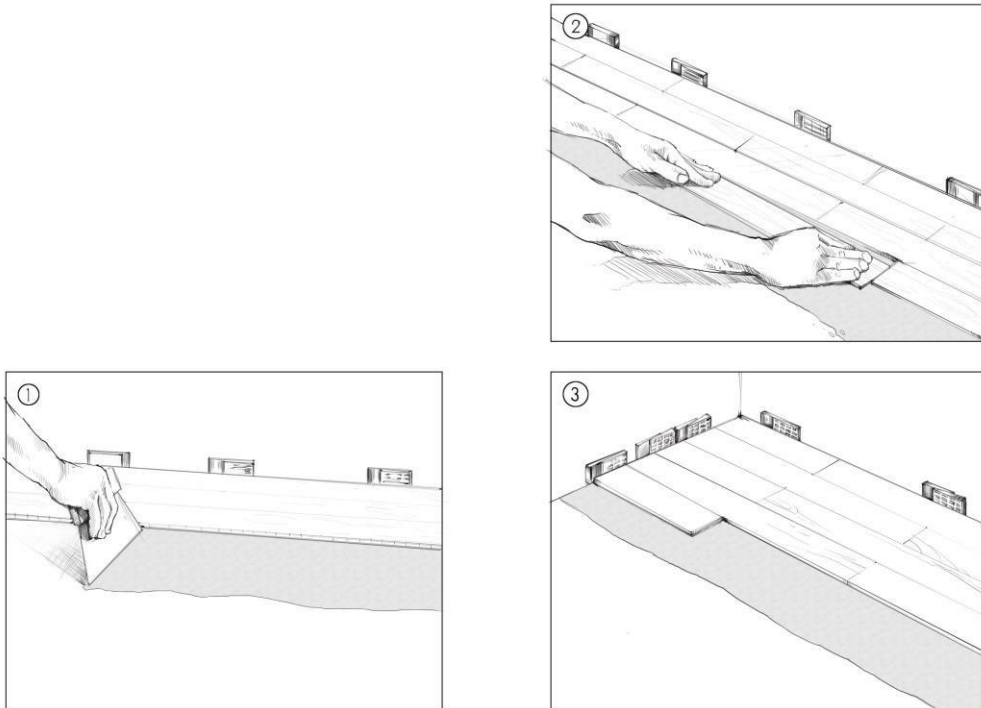

Picture 1 :

Stir glue thoroughly before use .Apply with notched applicator ,coverage approx. 800-1000 g/m<sup>2</sup> .

Install the flooring boards within 15 minutes .Start with the tongue side parallel to the wall in the case of tongue and groove surplus.

Picture 2:

The boards are taken directly from the carton and joined together in tongue and groove.

Picture 3:

Calculate wall spacing of approx. 10 mm with wedges.If necessary, place weights on the flooring boards around perimeter or at uneven areas.